



Evolution Edges

PACKED ICE CARBIDE KIT (PICK)

Introducing the Packed Ice Carbide Kit (PICK) from Evolution Edges and Castlebar. With unrivaled strength and Made in America quality, PICK penetrates the hardest of packed ice and snow environments.

Don't settle for anything less.

- ▶ Engineered to endure the most taxing and demanding road conditions.
- ▶ Designed for faster and more effective plowing over roads and runways with more extreme joints, cracks and inconsistent surfaces.
- ▶ Whole length of blade studded with dome-shaped carbide inserts enhancing durability.
- ▶ Fracture & chip resistant carbide design, results in longer wear and greater uptime.
- ▶ Reduces maintenance costs and blade breakage.

Castlebar Corporation is a leader in carbide insert manufacturing and used exclusively for the unyielding PICK system. Bringing more than 20 years of research, design and engineering in the carbide, metal cutting & manufacturing industries, Castlebar is further committed to service as a Service-Disabled Veteran-Owned Small Business (SDVOSB).

Innovation with an Edge

For more information, contact:
Daren R. Lynch
Director, Business Development
315.663.6529 | DLynch@EvolutionEdges.com

Jason Eoff
Regional Manager - West
505.975.0035 | JEoff@EvolutionEdges.com

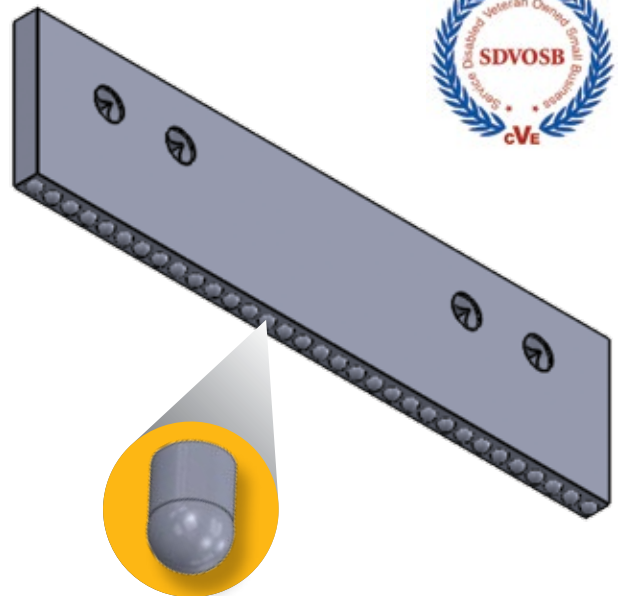

Evolution Edges, a Division of Chemung Supply Corporation, is an innovative blade and manufacturing company specializing in standard and custom snowplow edges. Known for its customer service, the company has been an authority on quality edges and wear parts for airports and municipalities offering an extensive product line of in-stock blades and edges ready for fast delivery.



2420 Corning Road
Elmira, New York 14903
EvolutionEdges.com